



nwa AIRLINK®

Passenger Safety



CANADAIR REGIONAL JET Passenger Safety Briefing Card



DO NOT REMOVE FROM AIRCRAFT

Exit Row seats

Please identify yourself if you cannot meet the following criteria/functions: If you have a condition preventing you from assisting, and are concerned with injury or wish not to assist in an emergency, notify the flight attendant so you may be relocated prior to door closure.

Any person sitting in an exit row must be able to meet all the following functional requirements:

- Be at least 15 years of age and able to perform all of the functions listed below without assistance:
 - Have sufficient mobility, strength or ability in both arms and hands, and both legs to:
 - (1) Reach upwards, sideways, and downward to the location of the emergency exit operating handle
 - (2) Grasp, push, pull or turn the operating handle
 - (3) Push, pull, shove or otherwise open the emergency exit
 - (4) Lift/throw out the size and weight of the overwing window exit door
 - Remove obstructions similar in size and weight. Doors might weigh as much as 40 lbs.
 - Reach the exit quickly
 - Maintain balance while removing obstructions
 - Go quickly through the exit
- Have no pre-existing condition that may cause personal harm or prevent the person from performing the functions
- Have no conditions or responsibilities, such as caring for a small child, which might prevent the person from performing the functions
- Be able to see well enough to perform the required functions. Person may wear glasses or contact lenses
- Hear and understand English well enough to hear instructions shouted by crewmembers. Person may wear hearing aid
- Be able to speak English well enough to give information to other passengers in an emergency
- Have the ability to read and understand English well enough to be able to perform the functions below

If you are seated in a designated exit row, you may be called upon to assist the crew in an emergency by performing the following functions:

- Customers seated in an exit seat may need to assist crewmembers in an emergency or if a Flight Attendant cannot reach the exit, these customers must know:
 - Where all exits are on the aircraft, know how to open the closest exit, as shown on the facing page, and follow all verbal and directional signals given by the crew.
 - Determine if it is safe to open, if fire, smoke or water could come into the cabin through the exit, it would not be opened.
 - That if it is safe to open the exit, it should be opened as quickly as possible. The pathway to the exit should remain clear. If the exit cannot be opened, they should direct others to a usable exit.
 - That if the exit is usable the customers must shout instructions to other customers to go out the exit as quickly as possible.
 - They must move away from the aircraft as soon and as quickly as possible.

Takeoff and Landing

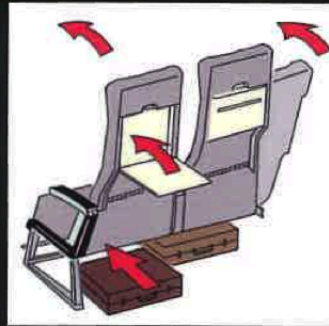

Fasten and release seat belt

For your safety we recommend you keep your seat belt fastened while you are seated.

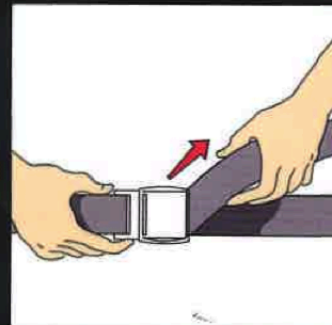
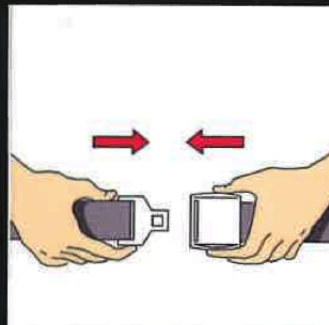

Brace positions



Federal Regulations require compliance with all safety instructions, including signs, placards, and instructions from crewmembers.



Portable electronic devices may be used only when notified by the crew members.

Entrance Door Exit - A



Assess conditions before opening

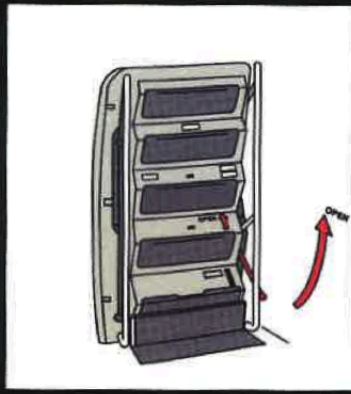

Emergency Exit - B



Assess conditions before opening



Window Exit - C



Assess conditions before opening



Oxygen Mask

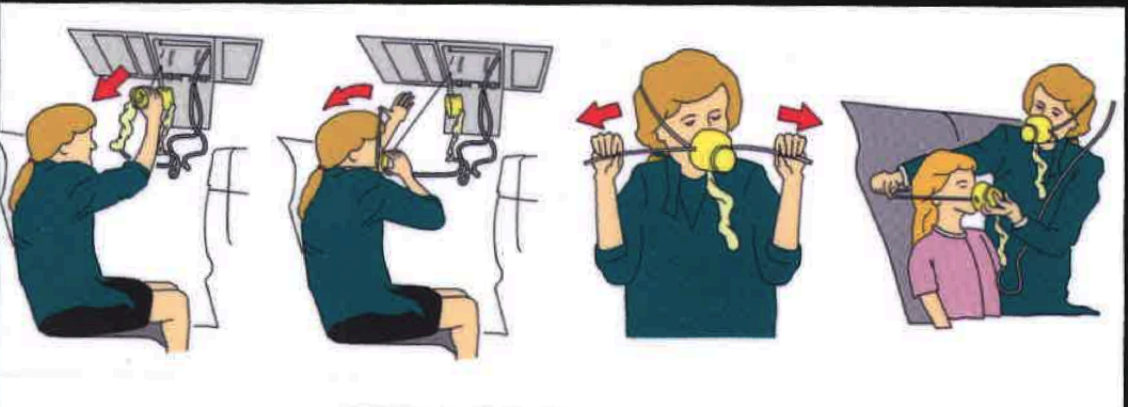
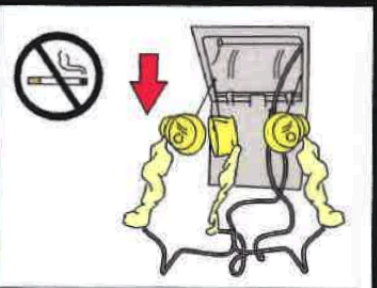

Emergency exit path

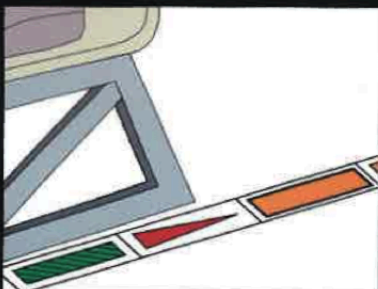

Either single or double path lighting. Colors of lights may vary. Follow path lights to emergency exits.

Flotation Seat Cushion

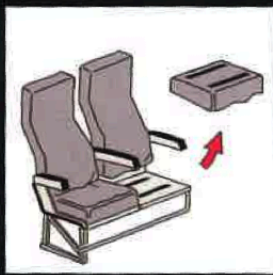

Infant Lifest

In the Event there is a Water Emergency the Flight Attendant will distribute the Infant Life Vests.

PLACE OVER HEAD



PLACE ONE LEG OVER HARNESS LOOP - PULL SNUG, BUT NOT TIGHT



BUCKLE BELT AROUND WAIST AND TIGHTEN



PULL RED TABS TO INFLATE



No Smoking

Smoking is prohibited on all flights between all U.S. cities, Canada, the Caribbean, Jamaica and Bermuda.

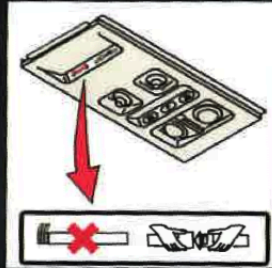

Land Evacuation

B. SERVICE DOOR

1. TURN HANDLE CLOCKWISE TO FULLY OPEN POSITION.
2. PUSH DOOR OUTWARD AND FORWARD TO THE LEFT.



A. PASSENGER DOOR

1. PULL HANDLE UPWARD TO FULLY OPEN POSITION.
2. PUSH DOOR DOWN.



C. EMERGENCY EXITS

1. REMOVE HANDLE COVER.
2. LIFT HANDLE TO STOP.
3. PULL DOOR INWARDS.

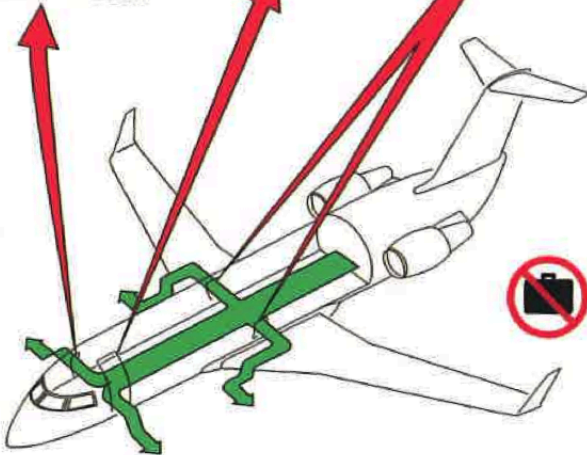

Water Evacuation

EMERGENCY EXITS

1. REMOVE HANDLE COVER.
2. LIFT HANDLE TO STOP.
3. PULL DOOR INWARDS.

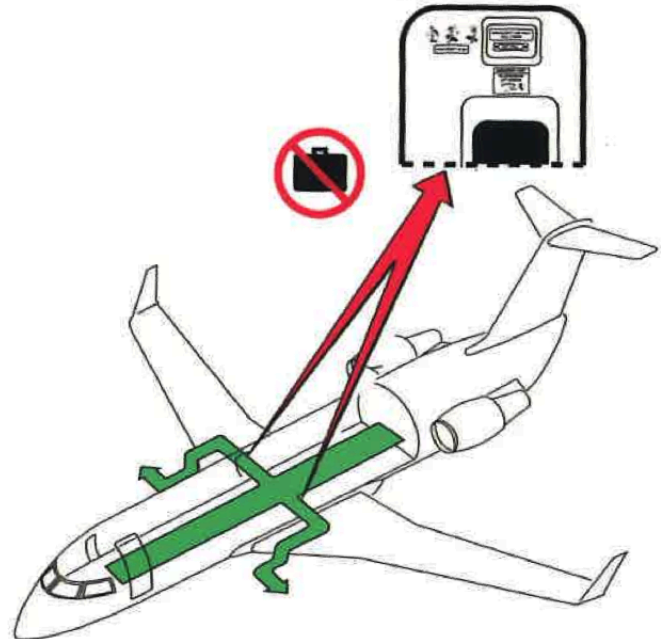

IFS-153

June 2005

Operated by:

Final assembly of this airplane was completed in Canada.



Your Safety is Our Number One Concern

